

Woodhall Spa Cottage Museum

Newsletter No.13 March 2013



Development
Progress



Woodhall Spa Cottage Museum

A Note from the Editor

Here we are with the first Newsletter of 2013, which promises to be a momentous year in the history of our Woodhall Spa Cottage Museum. Plans for the opening of the fully refurbished Museum towards the end of April are coming together, with an official opening to be arranged later in the year - watch this space! Rodger gives us an update on the museum development progress which is now at fever pitch, Jackie has written an article on page 3, giving us an insight into the planning of the new exhibits and Sarah Richards gives us her take on development of the Spa Baths on page 8.

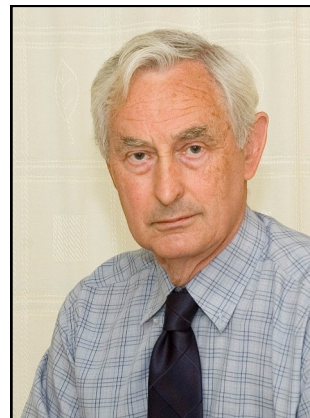

Apart from the excitement of the refurbishment of the Museum we also have two very worthwhile events coming up. The annual Museum dinner to be held on Friday March 15th at The Abbey Lodge will feature James Green, from The Kinema in the Woods, as the guest speaker. He was originally scheduled to be guest speaker two years ago but was prevented by the volcanic ash dust cloud which left him stranded in the United States for some days.. We trust there will be no further natural disasters to deprive us of what promises to be a fascinating talk. In May we are having a special lecture to be held at The English Golf Union Conference Centre. This is being given by Jim Shortland who will be talking about the Dams Raid, as May 2013 is the 70th anniversary of this famous event. More details are on page 20.

We are very pleased to welcome back our printer, Martin Taylor, who has returned to work following successful heart surgery. Our last issue was printed by Cupits for which we are very grateful, but we are delighted to be back in the capable hands of Martin.

It hardly seems possible that next time I put pen to paper the museum will be up and running, and we will all be enjoying the new exciting facilities. All the trials and tribulations of the development phase will be over! Did I hear a hurrah from Jackie and Rodger?

Philip Groves

Cover Pictures -

Main Picture - The Museum covered by a plastic tent to allow removal of the roof.

Small pictures clockwise from bottom left :- 1. Rear of museum after tent removed.

2. Under the tent with roofing removed

3. Wooden framework of outbuildings

4. Community Room with walls in place.

5. Community Archive & Bathchair store

In this Issue

New Displays	Page 3	Young Volunteers	Page 13
Development Update	Page 4	Ian Whittle's Visit	Page 16
Museum Accreditation	Page 7	Poppy's Page	Page 18
Development of the Spa Baths	Page 8	The Friends' Page	Page 20
Meet the Directors	Page 11		

The Newsletter Committee

Chairman - Paddy O'Neill Editor- Philip Groves Pam Cowlshaw David Radford

To contact the Newsletter Team please write to:-

The Cottage Museum, The Bungalow, Iddesleigh Road, Woodhall Spa, Lincs. LN10 6SH
or email phil.delia.groves@btinternet.com

Reg. Charity: 1114268 Reg. Museum:1929

The New Displays

The Bungalow refurbishment has reached the point where the interior can be accessed by the interpretation team. There have been an enormous number of volunteer hours spent in order for this to be achieved and credit must be given to Rodger Pickavance for his management of the capital work aspect of the development.

The interpretation team have not been idle. Over the past 12 months they have been working closely with Michael Oakenful from Querceus to design and plan new exhibition spaces. This hasn't been easy since the artefacts and photographic archive have been difficult to access.

We don't want to give you, the reader too much information about the new look museum since that would spoil the surprise element when you come to visit us. However, below is a copy of the

w o r k i n g
exhibition plan so
you can get a
flavour of what
awaits the visitor.
There have
been some
modifications,
one of which is
that the TIC
storeroom and
'kitchen' have
now swapped
places, you'll see
why when you
visit!

The museum has
a new entrance,
the old disability
ramp has been
removed and
access for all

visitors will be through the side door. The museum continues its partnership with ELDC's Tourist Information which will now be sited in our visitor reception area at the rear of the Bungalow., which will also house our small retail area.

The exhibitions and their interactive elements have been developed as a result of extensive consultation with community groups including schools and youth groups as to what they would like to see in the museum. Much of the written information for the graphic panels has been sought from individual residents who have particular expertise and knowledge of their subject and we really appreciate the time and effort they have taken in supporting us.

There continues to be much work to be done but the Directors look forward to welcoming you when the museum reopens in April.

Jackie Goodall

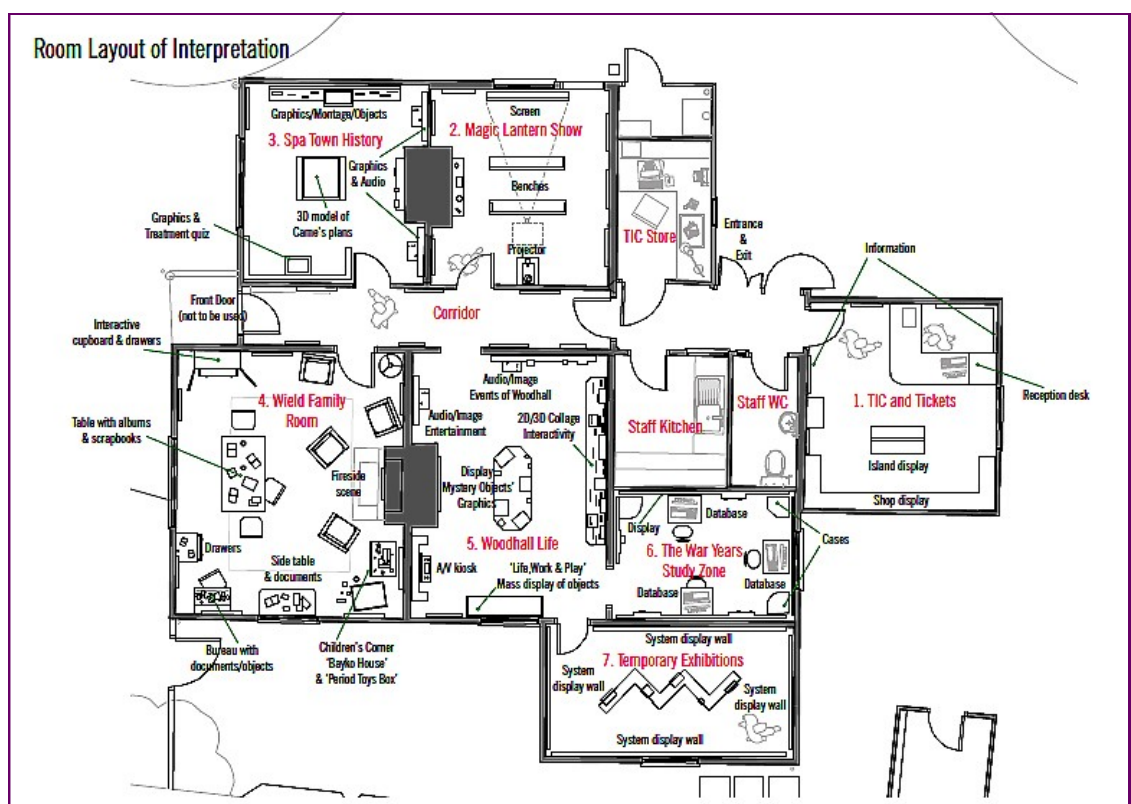

Art Exhibition

There will be an exhibition of work by Toni O'Neill at the Museum during the summer months - July to September
Look out for details

Woodhall Spa Cottage Museum

Development Update

We are now on the home straight as far as the building work goes, although the cold and wet weather as well as the snow, has caused some further delays and it will probably be spring before some of the outside coatings can be applied, due to temperature constraints. Additionally, plaster and paint don't dry too well when it's -4 deg C!



Insulating the Bungalow Roof

the chimneys also needed more extensive repair than had been forecast. All the insulation has been fitted to the roof and walls and the new heating system installed. At present, the decorators have nearly completed the internal decoration and the final fix of the electrics is well underway, with completion imminent.

The outbuildings have risen like a phoenix from the ashes and are well on the way to completion, with the internal decorators now moving in and the fixtures and fittings being installed. The new corrugated iron roof is also starting to mellow. The storage roller racking is in and the new furniture and computer systems will be arriving over the next couple of weeks.



Roller Racking in the Artefact Store



Interior of the Community Room

The clearance of the site and the landscaping of the courtyard area will run on for another couple of weeks and we hope that Mother Nature will cooperate to allow the contractors to finish. We also hope that Mother Nature will allow the front garden to recover, although she will probably need a helping hand.

The build side of the project has run late unfortunately, which has had a knock on effect on the display team's work, compressing their timeline, more on that from Jackie.

As in every other Newsletter, I put out a request to please continue to raise funds for the development appeal. We have had a couple of 'Why didn't we think of that when we were costing the project?', plus the 'gotcha's, and we have had to find funds to

pay for those items. On reflection, would we do this again?.....

Rodger Pickavance

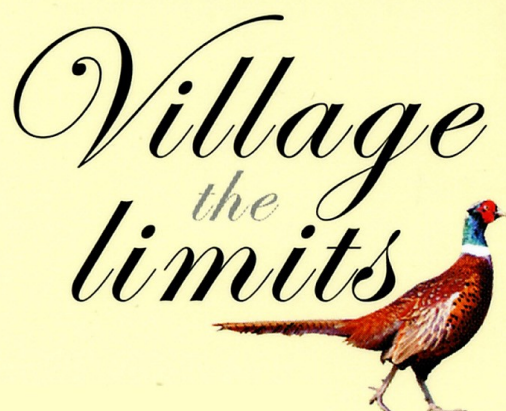

The Village Limits
Stixwould Road
Woodhall Spa
Lincolnshire
LN10 6UJ

t: 01526 353312
e: info@villagelimits.co.uk
w: www.villagelimits.co.uk

Avoid disappointment call ahead

Country Pub
and Motel
Restaurant



Billy & Sonia Gemmell
Hosts

Richard Sivill

GALLERY

**OLD PHOTOGRAPHS COPIED
INSTANT PASSPORT PICTURES
FULL FRAMING SERVICE
PICTURE GALLERY
ARTISTS MATERIALS
ENGRAVING SERVICE / TROPHIES**

4-6 High Street, Tattershall, Lincs.
Tel.: (01526) 345388

Woodhall Spa Cottage Museum

Visit

OAKLANDS~GRANGE PARKS

Horncastle Road, Woodhall Spa



A private park home estate offering both security and peace of mind. Developed to the highest standards with homes at affordable prices. You can be assured of a warm welcome.

Visit our new website on

www.oaklandsgrangeparkhomes.com

or for further details ring Heather Shepherd on

01526 352312

or email: oaklandsgrange@live.co.uk

or just “drop in”



MEDITERRANEAN BISTRO

the taste. the smell.
the passion.
the pleasure.

Open 7 days a week

12pm - 11:30pm

1 Station Road
Woodhall Spa
Lincolnshire
LN10 6QL

Tel: 01526 354466
Email: info@zucci.org
Website: www.zucci.org



adamcarter
solutions

All domestic interior & exterior
decorating projects welcome.

Visit my site and see the
standard.

www.adamcarter-solutions.com

Tel: **01526 352056**

Mob: **07795 692 179**

Historic Double for Spa's Cottage Museum!

Woodhall Spa's Cottage Museum volunteers were overjoyed to hear that their dedication to the preserving and sharing of the Spa's fascinating local heritage has recently been recognised by Arts Council England.

The renewal of Accreditation Status means that for the second time, the Woodhall Spa Cottage Museum is the first small independent museum in Lincolnshire to have been awarded this coveted status following the Arts Council's rigorous upgrading of the scheme.

The recognition of the volunteers' professionalism and high standards is an authoritative benchmark which all museums in England must achieve, if they are to keep pace with the times and be responsive to user needs and expectations.

Following closely on its award by the Heritage Lottery Fund of a grant towards the development of the site and its facilities, the Spa's historic Cottage Museum is looking forward to the reopening at Easter and for its improved heritage resource to become available for the local community and its visitors from afar to enjoy. Jackie Goodall, The Cottage Museum's Chairman commented, "What a wonderful Christmas present to know that our efforts have met national standards and, what is more, to have secured for Woodhall Spa and its community, a small portion of the two and a quarter billion pounds allotted by the Government and the Heritage Lottery Fund for the support of the Arts and Heritage."



*Patricia Duke-Cox & Jackie Goodall
With the Accreditation Certificate*

David Radford

Model Aircraft Presentation



Mrs Wiseman with the model Aircraft

A die cast model of a Mosquito aircraft has been donated to the museum by Mrs Wiseman. The model was originally given to her by her brother. Amongst their many other tasks Mosquitos were used by the Pathfinder Squadrons and may well have operated from RAF Woodhall Spa, though more research needs to be carried out to establish this.



D & B MOTORS

CAR REPAIRS AND
MOT PREPARATION

TYRES, BATTERIES
AND EXHAUSTS

Unit 1B
Tattershall Road
Woodhall Spa
Lincolnshire
LN10 6TW

01526 353904
07932 582551
07766 591641

DAVID & BRIAN ROW

MEMBER OF THE GOOD GARAGE SCHEME
dandbmotors@googlemail.com

Woodhall Spa Cottage Museum

Development of the Spa Baths

In 1821, John Parkinson, a Land Agent for Sir Joseph Banks of Revesby, sank a shaft to find coal in Woodhall Spa. He was unsuccessful in his quest but struck a spring of salt water in the process. Local Squire Thomas Hotchkin heard rumours about the curative properties of this water and found it helped his gout. He built a small bath house, which was enlarged as the news spread, and also a hotel. The hey-day of the spa was from 1890-1914 but water was used for rheumatic treatments until the middle of the twentieth century. In the 1980's, under the National Health Service, the Baths were under threat of closure when catastrophe occurred and the matter was decided. For on September 21st, 1983 a wall of the well collapsed, causing immense damage and the end of Woodhall Spa Baths.

Thirty years on, the building remains neglected, within an idyllic setting of woodlands. Many have expressed interest including Sir Richard Branson who visited on one occasion, however, as yet, regeneration has not been achieved. There would, of course, be substantial costs involved, whatever the change of use of the site; and its location, tucked away in woodland behind a small village in deepest Lincolnshire, makes it a very challenging opportunity for any business venture. Woodhall Spa already has a wide range of facilities, with established hotels, schools, a library, nursing homes and apartment facilities, so there may be no real village amenity left for a re-developed Spa Bath building to fulfil.

In my opinion a more appropriate solution may be in turning the former baths into a facility of multiple uses, incorporating memorabilia of John Parkinson, the catalyst for Woodhall Spa, and artefacts of the town's railway days with even broader aspects of the county's history. This would attract visitors from outside Woodhall Spa and possibly lottery funding.

In addition, another use for the area could be the creation of independent coffee shops, or some form of communal area for parents, perhaps mother and toddler groups and an after school go-to place for school children, as well as a cosy retreat before a matinee showing at the nearby Kinema in the Woods. Despite the current dilapidated state of the Baths, Woodhall Spa would not have achieved such popularity in the 19th century, which led to the growth of our well kept and highly regarded village today, if John Parkinson had not drilled for coal and uncovered the spring of water almost a century ago.

Sarah Richards

Donations to the Museum

Donations continue to flow in towards the Development Fund and these include a very generous gift of £1000 from the Olive Union Lodge of the Masons. £500 was donated by the Ballroom & Sequence Dancers from Coronation Hall, £500 from The Round Table, £250 from the Woodhall Spa Flower Club and £50 from Witham Ladies. The Directors would like to thank everyone who has donated to the Development fund. Contrary to belief that the museum is "awash with money" since receiving the grant from the Heritage Lottery Fund, a condition of the grant is that we have to provide matched funding of 10% - a target we still have to meet, so every penny counts.



Jackie receives the cheque from Robin Goodyear, Worshipful Master



Rodger Pickavance (right) receives the Round Table cheque from Peter Lee, Chair



Jackie Goodall accepts the cheque from Delia Groves & the Dancers from Coronation Hall



PREMIER PET CARE

QUALITY PET FOOD
AND ACCESSORIES

PROFESSIONAL FRIENDLY
SERVICE AND ADVICE

STOCKISTS OF ALL MAJOR
BRANDS PLUS EVERYTHING
AVAILABLE TO ORDER

FREE LOCAL DELIVERY

01526 352626

Unit 1, The Broadway Centre, The Broadway
WOODHALL SPA, Lincs. LN10 6ST
mail@premierpetswoodhallspa.co.uk
www.premierpetswoodhallspa.co.uk

Grimsby Town Fish Products

on The Mall car park

**every Friday morning
10.00 - 12.00 noon**

for HOME DELIVERIES

ring JOHN on 07708 596982

Pitchaway Guest House

*Enjoy the unique
welcome, hospitality
and comfort of
Pitchaway guest house.*



Situated in a premier position within
two minutes walk of the Woodhall Spa National
Golf Centre, the home of amateur golf in England,
this impressive Edwardian family residence could
be your home-from-home.

Pitchaway has ample parking space for eight cars.

Single, twin, double and family rooms are available
from only £42.00 per room
Traditional full English breakfast is served in our large
dining room

Contact us for enquiries or to make a reservation



The Broadway, Woodhall Spa, Lincolnshire LN10 6SQ
+44 (0)1526 352969 info@pitchawaybandb.co.uk www.pitchawaybandb.co.uk



**The Bakery and Delicatessen
of Woodhall Spa**
are proud to offer

Fresh Bread and Rolls Baked Daily
Pastries and Fancy Small Cakes
and
Celebration Wedding & Birthday Cakes
All baked daily on our premises

Woodhall Spa Cottage Museum

Ristorante Il Parco *is now at The Tea House in the Woods*



Serving Teas, Coffees and Drinks
Lunches, Light Meals and Children's Menus

Also Every Evening
Our Specialised Homemade Italian Cuisine
Surrounded with a beautiful atmosphere and relaxing views

We look forward to seeing you

Ristorante Il Parco at The Tea House in the Woods
Coronation Road, Woodhall Spa, Lincolnshire LN10 6QD

01526 354455

Visit our Website for Christmas Menus and Special Events
www.ristoranteilparco.co.uk

India Village

6 The Broadway
Woodhall Spa
Lincolnshire LN10 6ST
Tel: 01526 352223/354657



Opening Times
Midday - 2.00pm
5.30pm - 11.30pm
7 Days a Week

**10% Discount
on Take-Aways**

*For the Best Indian
and
Eastern Dishes*

World Renowned **Janet's** *Traditional English Tea Rooms*



HOME MADE
PRESERVES

FREE RANGE EGGS

BRIC A BRAC



Opposite Dambusters Memorial

18 Station Road
Woodhall Spa
Lincolnshire LN10 6QL

PROPRIETOR: JANET HUNT

THE MELROSE

BROADWAY CENTRE WOODHALL SPA

A warm friendly family run
business hidden away at the
bottom of the Broadway Centre,
serving back to basic's,
home-cooked foods using
local produce.

Open 9am Monday - Saturday

Breakfasts
Home cooked lunches
All day menu

TEL 07983638246
OR
07930878803

Meet the Directors - Tom Johnson

The year 1970 played a large part in my life, providing two challenges. Firstly, I changed Government Departments, leaving the Inland Revenue and joining the Social Security. Secondly, and more rewardingly, I got married in the October to Christine!

We lived in East Grinstead where we both worked in Redhill. My job in the Social Security Department was as a National Insurance Inspector investigating those employers and self-employed who did not comply with the N.I. Acts, along with other related issues including investigating fraudulent misuse of National Insurance benefits. I remember one particular day, which covered the broad spectrum of the job, when I had a morning visit to the home of the Earl of Munster following the theft of his staffs' National Insurance cards and in the evening, visiting the Surrey gypsy camp, where I was known and never welcomed! For some years I worked as a trainer in the Guildford and Worthing offices.



My final 12 years were with the Social Security Appeals Tribunal where I latterly became the Property Director responsible for 80 offices around the UK. One of my last projects was acquiring and fitting out an office in Salford for the administration of Appeals for the Child Support Agency. The introduction of the C.S.A. necessitated me to revamp many of the Tribunal venues and one such visit was to the Lincoln property!

My office base at the time was off the Tottenham Court Road and living in Storrington, West Sussex, close to the south coast, meant a round trip to London on the days I was in the office of over 4 hours. The advent of a Public Finance Initiative (PFI) scheme for the whole property portfolio of the Department of Social Security relieved me of my journey to London!

Following a few years working in the Housing Department of Crawley Borough Council we decided to call it a day and move to Woodhall Spa. Why Woodhall Spa?

Many of you know Christine and we have a married son and three grandchildren living in Perth Australia, having recently moved there from Cardiff. We also have a married daughter and another grandchild living in Surbiton.

My involvement with the Development Committee and the care of the museum artefacts has greatly helped us to integrate into one of the friendliest places you could find to live. That's why Woodhall Spa.

Tom Johnson

Rescheduled Opening of the Cottage Museum

The Museum will re-open to the public following the refurbishment program towards the end of April. The various delays which have occurred, due largely to the unforeseen problems with the foundations, has meant that the display team have not had access to the Museum until the end of February, instead of the beginning of January. In order that this very important phase of the development program should be completed to the highest standards, the decision was taken to wait until the end of April before opening to the public. The Tourist Information Centre however, will open from Good Friday as originally planned.

Woodhall Spa Cottage Museum

The Mall Woodhall Spa

Under new Ownership

Come and visit us we are open
7 days a week all are welcome

Food is served daily Mon-Sat
starting from 10am through till 8.45pm
And on Sundays 12 noon till 8pm.

Come and join us every Sunday at 8.30
for our fun pub quiz

Private functions are catered for...

For more information call us on

01526 352342

or visit our website and send us an email

www.themallwoodhallspa.com

Foot Health Professional

Jeanne Bollard
MAFHP MCFHP

jeannebollard@hotmail.com

07799 400631

01526 352398

14 Stanhope Avenue
Woodhall Spa
Lincs. LN10 6SP



BROADWAY CARPETS & CURTAINS LTD



For all your soft
furnishing requirements

Curtains, Carpets, Wallpaper,
Blinds, Awnings,
Parker Knoll Furniture
& Lighting Showroom

Come and visit us in the Broadway, Woodhall Spa.
Open: Tues – Fri 9.00am-5.30pm Sat 9.00am-5.00pm

Matthew Temple House, The Broadway,
Woodhall Spa. Lincolnshire LN10 6ST
Tel: 01526 353484 Fax: 01526 353584

E-Mail: broadwaycarpets@btconnect.com
Website: broadwaycarpetsandcurtains.co.uk

Young Volunteers

As part of the volunteering section of our Silver Duke of Edinburgh Award, we have recently been working at the Cottage Museum. We have written this article to give you an idea about what it is like to be young people forming a part of a volunteer-run organisation in Lincolnshire.

Having lived in Woodhall Spa since we were very young, we have both visited the Cottage Museum on previous occasions. However, we were first introduced to the idea of volunteering there by our neighbour, Mrs Gill Noble, who is a dedicated volunteer at the museum. She helped to set up



Grace Hillsmith left and Hannah Bass in the Museum garden

some of our first volunteering opportunities and we were at once drawn in by the museum's unique and friendly atmosphere; it being entirely volunteer run means all the staff are there because they want to be and are clearly enthused by the fact they are helping to bring the history of our village and surrounding area to life.

So far we have been involved with a range of activities and projects which include redesigning the children's quiz, clearing areas of the garden, analysing data from the previous year's questionnaire, improving the questionnaire for this year, and even using hand-held cameras to film parts of the Woodhall Spa Pageant last summer: the sheer diversity of these activities has meant that each day at the museum is never the same and you can always find something interesting to get involved in.

Looking to the near future, we are currently making Victorian money that will be used in children's activities as we feel having more child-friendly parts of the museum would help to attract more families. This means the history this wonderful little museum preserves is sure to be passed down to younger generations.

In the more distant future, we both intend to go to university but are looking forward to visiting the museum when we come home to see how it has evolved.

It has been a real privilege to be involved with helping to improve the museum and to be part of some fantastic community events: these opportunities have made our volunteering experience both highly enjoyable and fulfilling.

Grace Hillsmith and Hannah Brass

125 Club Winners

November

£20 Roy Goodall (70)
£10 Nigel Bush (20)
£5 Carol Webb (105)

Annual "Big Prize" Winners

£125 Josie Selby (86)
£60 Nicholas Duke-Cox (25)
£30 Sam Leggate (39)

RUSSELL GREEN

Residential Care Home for the Elderly
11 Stanhope Avenue, Woodhall Spa
Lincolnshire LN10 6SP



Set in the beautiful village of Woodhall Spa.
With a short level walk to all the village amenities
24 hour care provided by professionally trained staff

A Home Care Service is also available
taking the same standard of care
and commitment out into the local community

For more detailed information visit our web site at
www.russellgreencarehome.co.uk
telephone: 01526 352879

01526 352538

**LUNCH & DINNER
MON -SAT**



**SUNDAY
LUNCH
12 - 2 pm**

**ABBEY LODGE INN - KIRKSTEAD
WOODHALL SPA**

DON'T BE DISAPPOINTED!!

REMEMBER TO BOOK YOUR TABLE FOR YOUR NEXT VISIT

WEDDINGS ANNIVERSARIES BIRTHDAYS
MEETINGS DINNER DANCES BUFFETS
OR OTHER SOCIAL FUNCTIONS

OUR MONK'S ROOM HOLDS 100 - 150 PERSONS



**The Vale, 50 Tor-O-Moor Rd.
Woodhall Spa LN10 6SB
01526 353022**

e-mail margot.mills@hotmail.co.uk

Margot and John welcome you to the Vale. Enjoy your full English breakfast overlooking our lake, watching the wildlife. All this within half a mile of a famous golf club and the village

Oglee Guest House

*Family-Run Guest House
situated on a peaceful
tree-lined avenue close to
the centre of Woodhall Spa*

All Rooms En-Suite

*16 Stanhope Avenue
Woodhall Spa
Lincs.*

Tel: 01526 353512

Woodhall Spa Cottage Museum

Ian Whittle's Visit to Woodhall Spa

Last year's excellent Memorial Lecture entitled "Genesis of the Jet" was presented by Ian Whittle, the son of Sir Frank Whittle. The lecture was delivered at the Conference Centre of the English Gold Union on the afternoon of Saturday November 10th. But his visit to Woodhall Spa began the previous morning. He flew in to the former RAF airfield at Wickenby where he was met by Pam Cowlshaw and Phil Groves.



Ian Whittle arrives at Wickenby



His first port of call was a visit to the Aviation Heritage Centre at East Kirkby, where David Hill was on hand together with the museum owner Fred Panton. Following coffee and a lively exchange of aviation stories Ian was taken on a guided tour of "Just Jane", the Lancaster Bomber where he was delighted to sit in the cockpit of this iconic aircraft.

Following lunch in the NAFFI the whirlwind tour continued with a visit to the Battle of Britain Memorial Flight at RAF Coningsby. He was given the full VIP treatment and taken on a guided tour

of the exhibits. He also had an in depth discussion on Jet engines with the Flight's Engineering Officer.

On Saturday morning he was picked up from the Petwood and taken for a visit to the museum at RAF Metherringham before returning to deliver the lecture on Saturday afternoon.. A large audience had assembled and were enthralled by his stories of his father's exploits and some fascinating film of early experiments with which his father had been involved. A dinner followed on Saturday evening in The Squadron Bar of The



Ian Whittle with the BMBF Lancaster



Petwood. Sunday morning was Remembrance Sunday and Ian attended the services held at the village War Memorial and afterwards at the Dambusters Memorial. Following a spot of lunch it was time to drive back to Wickenby and fly home.



Philip Groves

Grand Draw for Snowy the Aviator

Snowy, the white Teddy Bear, who was flown by the BMBF last summer on most of their prestigious flights, was handed over to Ian Whittle during his visit by Yvonne Masters, BMBF Public Relations Officer. The draw was launched by Pam Cowlshaw at the Memorial Lecture the following day. Snowy, complete with his log book, will be at the Annual Museum Dinner on March 15th. and at the Museum once it re-opens. Tickets cost £1 or £5 for a book and the draw will take place at the Dams Raid Lecture on May 11th.



EBRINGTON ARMS

MAIN STREET KIRKBY ON BAIN LN10 6YT



Food is served Tuesday to Sunday
between noon and 2pm and 6pm - 9pm
Sunday Lunch available noon - 2pm

A family run traditional pub restaurant
serving good home cooked food
with a selection of cask and keg
ales. (CAMRA Good Beer Guide)
3.5 miles from Coningsby
and 2 miles from Woodhall Spa.

Families, children and dogs welcome.
The bar has a warm coal fire in winter.
Outside the patio area is covered
ensuring a dry seat whatever the
weather and the pleasant beer garden
has a gazebo and children's play area.

**All Year Round -
A great place to eat
and drink!
(Always advisable to
book - Telephone 01526 354560**



Petwood WOODHALL SPA



The Petwood is a Delightful Edwardian Country House hotel, set in 30 acres of secluded gardens and woodland. Home of the Dambusters during the second world war. Having extensive conference, wedding and special event facilities and offering short holidays and Golfing breaks with 53 bedrooms all individually designed. Member of "Tastes of Lincolnshire" the Tennyson's Restaurant promotes local produce.

The Petwood is a friend and supporter of the Woodhall Spa Cottage Museum.



POPPY'S PAGE

I hope you enjoyed Christmas and all the snow in January - I did! In this issue Marjorie Sargeant has written about Easter and how it would have been for children in Woodhall Spa back in 1913. We also have a Missing Word Puzzle for you set by Gill Noble. Enjoy - See you next time.

Poppy



Easter in Woodhall Spa 100 Years Ago

Hello Everyone!

Easter is almost here!

I am glad because I stopped eating sweets for Lent! I love Liquorice Allsorts -especially the pink, coconut ones!

Pancake Tuesday was fun. I helped Mama mix a batter of flour, salt, eggs and milk and then we poured a little into hot fat in an omelette pan and tipped it round before flipping it over. We each tossed a pancake, to see whose went highest. My brother's missed the pan and fell on the floor!

Before Easter we hard boil eggs with onion skins to make them an orange colour and then we paint faces on them. On Easter Sunday we have fun with an Easter Egg Hunt for Fry's chocolate eggs, hidden by Papa in the garden.

We have new clothes to wear for church on Easter Day and Easter bonnets, of course. Grandma's is always huge and decorated with flowers. I am glad we live near church because some of our footpaths are in dreadful condition (there have been complaints to the Council) and holes are filled in with gravel which would ruin my new, shiny black shoes.

Grandma will be visiting us and telling us about Fabergé eggs – again! I have seen pictures of them made by the Russian royal jeweller and they are very beautiful but I hear the story every year and we won't know what this year's egg is like until much later.

Easter is early this year. There will be lots of day trippers on Easter Monday, with ladies in beautiful long gowns, strolling in our pinewoods, taking tea at the Teahouse and listening to the Spa Band playing near the Baths, with little red squirrels scuttling around. Papa is looking forward to seeing the motor cars in which more and more visitors are arriving.

Happy Easter!

Marjorie Sargeant



A Fabergé Egg - A very expensive jewellery Item often given at Easter

A Missing Word Puzzle

Set by Gill Noble

B	F	J	P	W
Q	T	V	Z	C
R	X	D	H	L
O	S	Y	U	G

Find the six missing letters from the alphabet and re arrange them to make the name of a well known attraction in Woodhall Spa.

Answer on Page 8



WILLOW HOLT

Caravan & Camping Park

- **TENTS & CARAVANS**
- **STATIC HIRE & SALES**
- **ACCESSORY SHOP**

LODGE ROAD, TATTERSHALL. LN4 4JS

TEL: 01526 343111

The Friends of the Woodhall Spa Cottage Museum

Committee Members:

Chairman: Pam Cowlshaw	01526 352112
Ann Houlton	01526 352323
Paddy O'Neill	01526 354982
Roger Webb	01526 353029

Hello Friends,

This year promises to be an exciting one for all of us associated with the Cottage Museum. The capital works and the new and innovative displays are now nearing completion and a programme of activities designed to train volunteers and aimed at involving members of our community in the day to day life of the museum, will be well under way.

As Friends we have a role to play too. The museum is providing more and more facilities and so our running costs are increasing proportionately. As members of the Friends we contribute with our annual subscriptions and for those that help at events or even just attend them we contribute with our time too. But we can do more.

There will be lots of publicity surrounding the reopening of the museum in the Spring and here we can play a part by spreading the word, letting our friends, neighbours and relations know about the museum. A little encouragement can go along way towards increased Friends Membership, or just a visit to the Museum.

If you have any ideas for fundraising schemes, or would like to help at any of the ones already organized, please contact one of the committee listed above.

We have a busy year of events planned for this year and would be pleased to see as many of you as possible at any or all of them. Details of each event are on our website www.cottagemuseum.co.uk so take a look and select the ones that you are interested in.

Finally, Ann Houlton has decided to retire from the Committee of the Friends at the AGM in September and a replacement will be needed. Please give this opportunity to join an enthusiastic and vibrant team serious thought. If you would like to ask about the role of a Friends Committee member and what you have to offer please give me a ring.

Best wishes for 2013.

Pam Cowlshaw



Woodhall Spa
Forthcoming Attractions of
a Museum orientated
nature:

Museum Dinner
Abbey Lodge
Speaker James Green
from The Kinema
March 15th 2013

Special Lecture
"The Dams Raid"
Jim Shortland
11th. May
2.30 pm at the EGU

Woodhall Show
19th May 2013
Stall selling memorabilia
and playing of games

Woodhall Spa
Cottage Museum
Market Day
25th May 2013
Events in Coronation Hall
St. Peter's Hall and
museum garden.
Stalls, some commercial
and some local charities
and groups selling and
displaying their activities.

See also
www.cottagemuseum.co.uk
and
www.woodhallspa.org

